

RATIONAL

design by Spazio



- LED Footlight
- Body made in aluminium
- Includes mounting plate and driver
- The mounting plate is designed for a standard 4 x 4 junction box which is fully recessed into the wall and plastered over (Fig. 2)
- Available in the following options:
 - Round: 2W/230V LED 3000/4000K
 - Square: 3W/230V LED 3000/4000K
- Includes LED driver
- Class II
- IP 54
- Inland Quality

Fig. 1 Complete with mounting plate

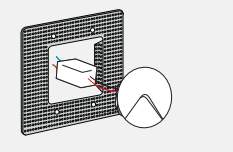
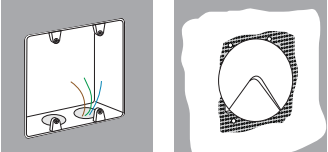
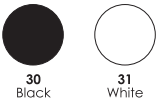

Fig. 2 Attach the plate, connect the fitting and plaster over





code lamp details

Round

2379.01.30.30	2W	230V	3000K
2379.01.40.30	2W	230V	4000K
2379.01.30.31	2W	230V	3000K
2379.01.40.31	2W	230V	4000K

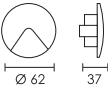
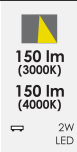

Includes mounting plate for 4 x 4 box and LED driver.

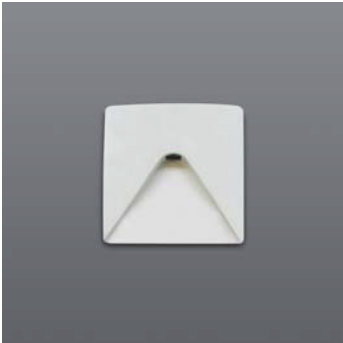

code lamp details

Square

2379.02.30.30	3W	230V	3000K
2379.02.40.30	3W	230V	4000K
2379.02.30.31	3W	230V	3000K
2379.02.40.31	3W	230V	4000K

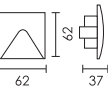
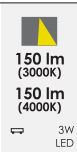

Includes mounting plate for 4 x 4 box and LED driver.

