

INSTRUCTIONS



TIME & AGAIN CEILING LIGHT

8964.3030

8965.3030

Please read the instructions before commencing installation and retain for future reference.

SPECIFICATIONS:

- **Fitting:** Aluminum body and acrylic diffuser.
- **Lamp type:**
8964: 12W / LED 3000K D.110*H.131.5mm
8965: 18W / LED 3000K D.160*H.131.5mm
- **Protection against electric shock:** CLASS I. Require an earth connection.
- **Ingress Protection:** IP20. Protection against the entry of solid bodies with dimensions more than 12mm.
- **Quality/Corrosive rating:** Suitable for domestic and commercial indoor applications.

INSTALLATION INSTRUCTIONS:



Electrical products can cause death, injury, damage to property. Installation of this product must be carried out by a qualified electrician, in accordance with SANS 10142. On completion of installation, ensure that the Certificate of Compliance is updated.



CAUTION: Risk of electric shock

Ensure mains supply is switched off.

- Remove the ceiling plate by unscrewing it from the fitting base and fix it to the ceiling. (Fig.1)
- Connect the fitting to its electrical source.
Brown (Live) - to Brown or Red
Blue (Neutral) - to Blue or Black
Green/Yellow (Earth) - to Green/Yellow or Copper. (Fig. 2)
- Re-attach the fitting to the ceiling plate. (Fig.3)

Switch on the mains supply (Fig. 4)

WARNING:

- Ensure all items and screws are secure and fitted correctly.

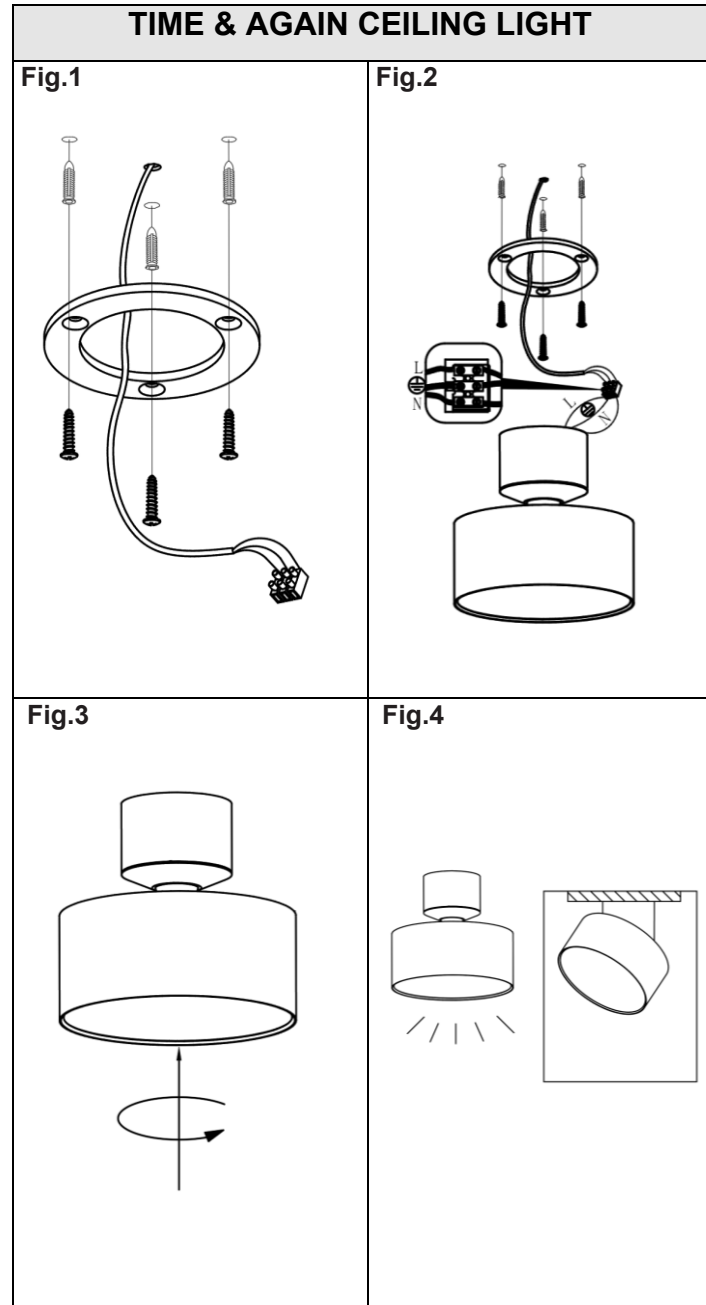

Spazio Lighting (Pty) LTD.

JOHANNESBURG OFFICE: 52 Andries Street | Wynberg/Sandton

CAPE TOWN OFFICE: 36 Milner Street | Paarden Eiland

DURBAN OFFICE: 31 Solstice Road | Umhlanga Ridge

011 555 5555 (Central Switchboard) | info@spazio.co.za