

INSTRUCTIONS

COMET CEILING FITTING

8952.01 8952.02

Please read the instructions before commencing installation and retain for future reference.

SPECIFICATIONS:

- **Fitting:** Glass diffuser with metal base.
- **Lamp types:** max.1 x 60W / E27
- **Protection against electric shock:** CLASS I. Requires earth connection.
- **Ingress Protection:** IP20. Protection against the entry of solid bodies >12mm
- **Driver:** Not applicable
- **Quality/Corrosive rating:** Suitable for domestic and commercial indoor use, except in corrosive environments.
- **Ambient temperature range:** -20°C to +50°C.

INSTALLATION INSTRUCTIONS:

⚠ Electrical products can cause death, injury, damage to property. Installation of this product must be carried out by a qualified electrician, in accordance with SANS 10142. On completion of installation, ensure that the Certificate of Compliance is updated.



Warning: Risk of Electric Shock

Turn off mains supply

- Remove the mounting bracket and diffuser from the base. (Fig. 1)
- Mark and drill two holes where you want to install the fitting and insert the screw anchors into the ceiling. (Fig. 2 a and b)
- Pierce the grommet on the mounting bracket using a round tool smaller than the cable size and thread the mains cable through. (Fig. 3)
- Install the correct lamp as illustrated. (Fig. 4)
- Re-attach the diffuser. (Fig. 5)
- Connect the mains supply to the fitting using the terminal block provided. (Fig. 6)
 - Brown (Live) – to Brown
 - Blue (Neutral) – to Blue
 - Green/Yellow (Earth) – to Green/Yellow
- Fix the fitting base to the mounting bracket. (Fig. 7)

Turn on mains supply (Fig. 8)

WARNING:

- Ensure all items and screws are secure and fitted correctly.

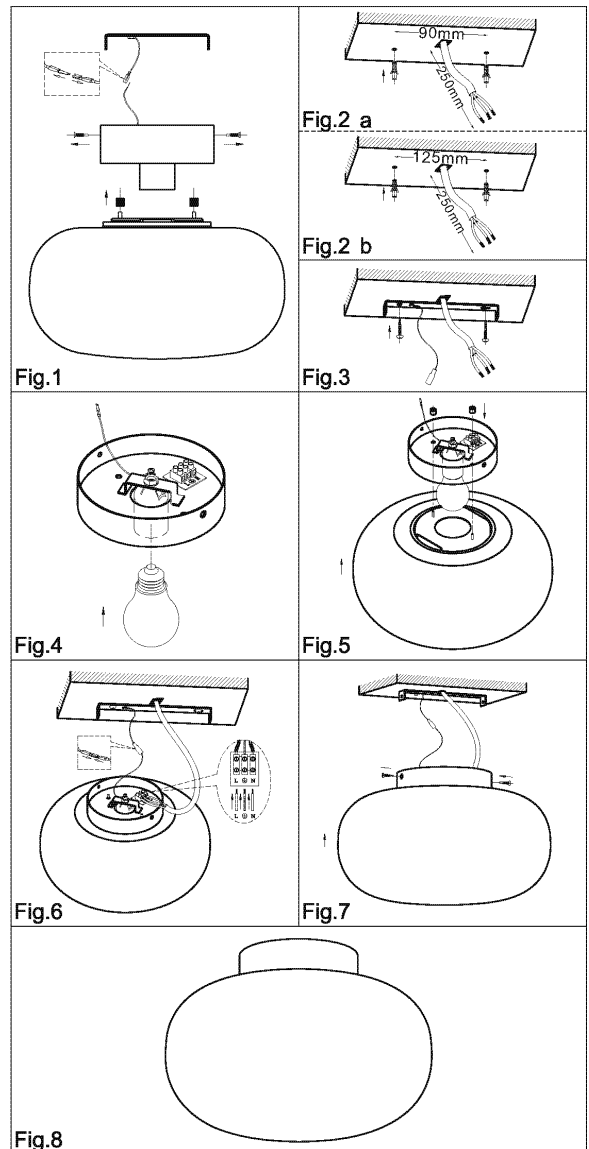

Spazio Lighting (Pty) LTD.

JOHANNESBURG OFFICE: 52 Andries Street | Wynberg/Sandton

CAPE TOWN OFFICE: 36 Milner Street | Paarden Eiland

DURBAN OFFICE: 31 Solstice Road | Umhlanga Ridge

011 555 5555 (Central Switchboard) | info@spazio.co.za