

INSTRUCTIONS

1200mm RING LED PENDANT



Art. No. SPE.8585.120.30.30D

Please read the instructions before commencing installation and retain for future reference.

SPECIFICATIONS:

- **Fitting:** Aluminium frame, metal base + polycarbonate diffuser
- **Lamp types:** 75W 3000K 230V LED
- **Protection against electric shock:** CLASS I. Requires earth connection.
- **Ingress Protection:** IP20. Protection against the entry of solid bodies with dimensions > 12mm
- **Ballast:** Includes LED Driver
- **Quality/Corrosive rating:** Suitable for indoor commercial and residential applications
- **Ambient temperature range:** -8°C to +55°C.

INSTALLATION INSTRUCTIONS:

⚠ Electrical products can cause death, injury or damage to property. Installation of this product must be carried out by a qualified electrician, in accordance with SANS 10142. On completion of installation, ensure that the Certificate of Compliance is updated.

Ensure main supply is switched off.

- Mount two expansion anchors (supplied) on the ceiling. (Fig. 1)
- Mount the ceiling bracket to the anchors with the screws provided. (Fig.2)
- Connect the fitting to its electrical source using the terminal block provided. (Fig. 3)
Brown (Live) - to Brown or Red
Blue (Neutral) - to Blue or Black
Green/Yellow (Earth) - to Green/Yellow or Copper.
- Fix the fitting base to the ceiling bracket. (Fig. 4)
- Adjust the length of cables as needed. (Fig. 5)

Switch main supply back on and test the fitting.

WARNING:

- Ensure all items and screws are secure and fitted correctly.



Caution, risk of electric shock

1200mm RING LED PENDANT

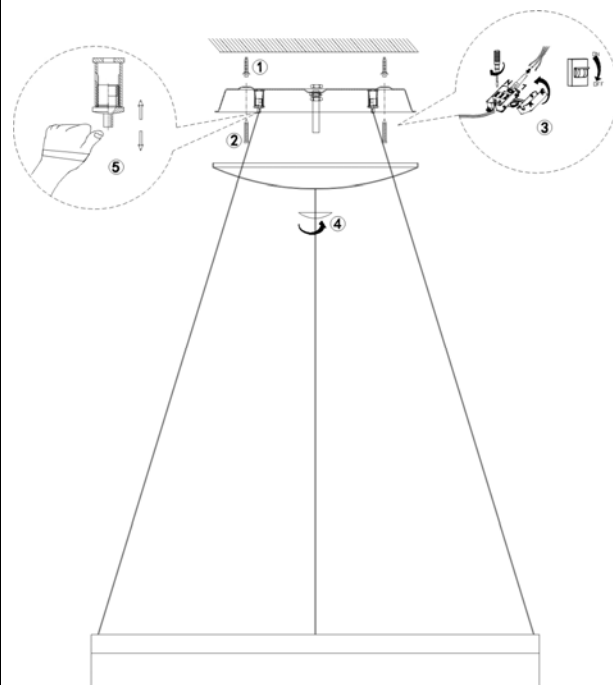
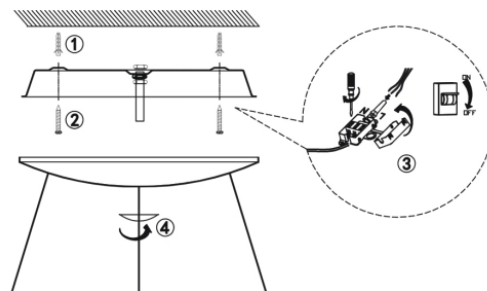

Spazio Lighting (Pty) LTD

JOHANNESBURG OFFICE: 52 Andries Street | Wynberg/Sandton | Tel: +27 11 555 5555 | Fax: +27 11 555 5544

CAPETOWN OFFICE: 36 Milner Street | Paarden Eiland | Tel: +27 21 461 0061 | Fax: +27 21 461 0063

DURBAN OFFICE: 31 Solstice Road | Umhlanga Ridge | Tel: +27 11 555 5555 | Fax: +27 11 555 5544

info@spazio.co.za